

**PLAN**

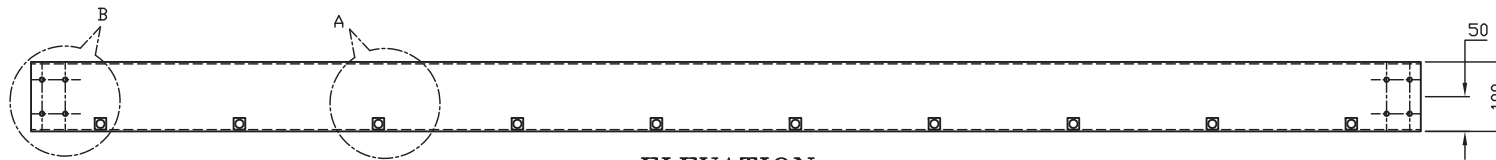

**ELEVATION**

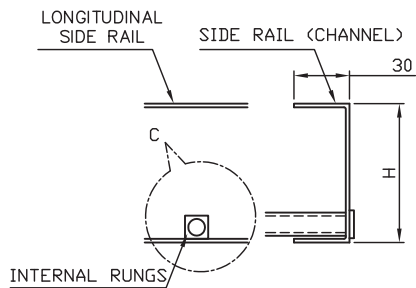

**DETAIL-A**

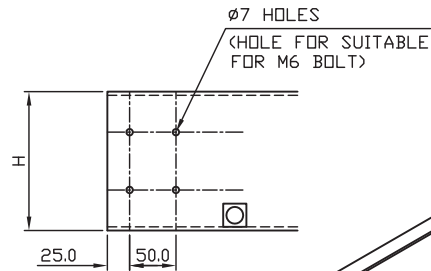

**DETAIL-B**

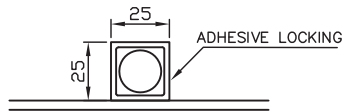

**DETAIL-C**



**DETAIL-C**

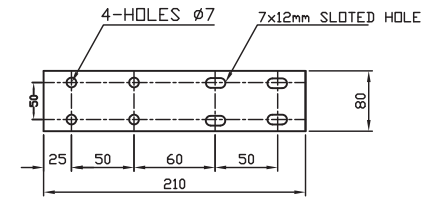

**FRP COUPLER PLATE  
SIZE: 80x210x4mm**

1NO. CABLE TRAY REQUIRED 4NOS. OF  
COUPLER PLATES & 16 SETS OF SS HARDWARE

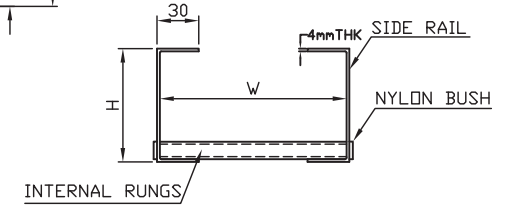

**SIDE VIEW**

NOTES :  
1. ALL DIMENSIONS ARE IN MM

W	H	THK
150mm	100mm	4mm
300mm	100mm	4mm
600mm	100mm	4mm

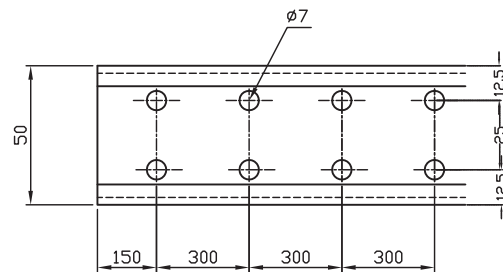
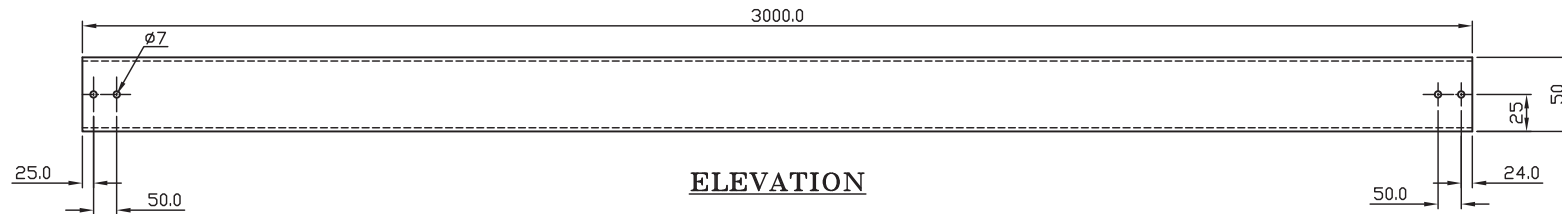
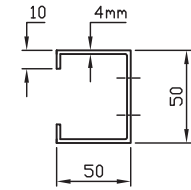
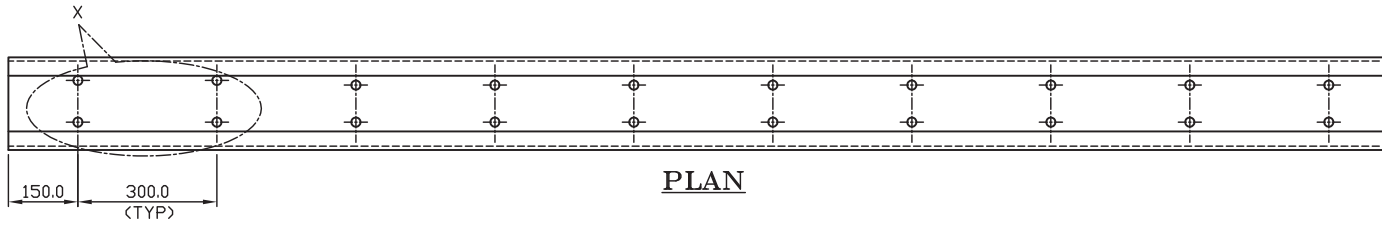

NOTES :  
1. ALL DIMENSIONS ARE IN MM

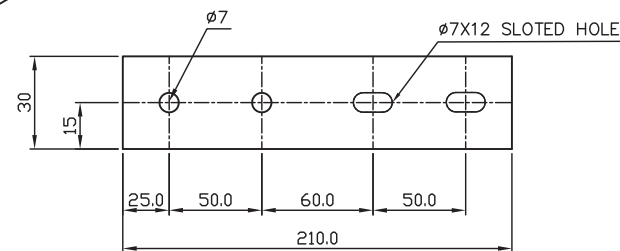

CABLE TRAY REQUIRED 8 SETS OF  
SS HARDWARE

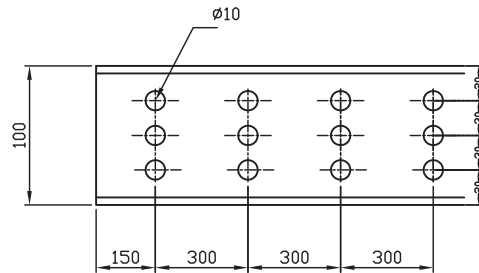
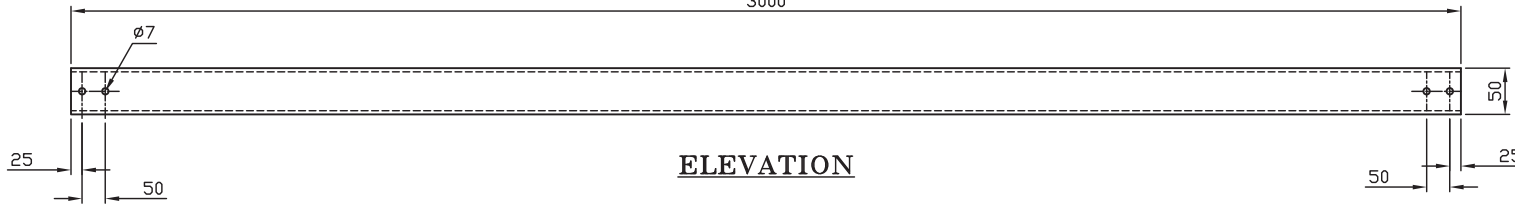
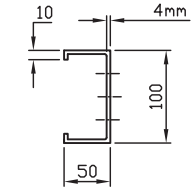
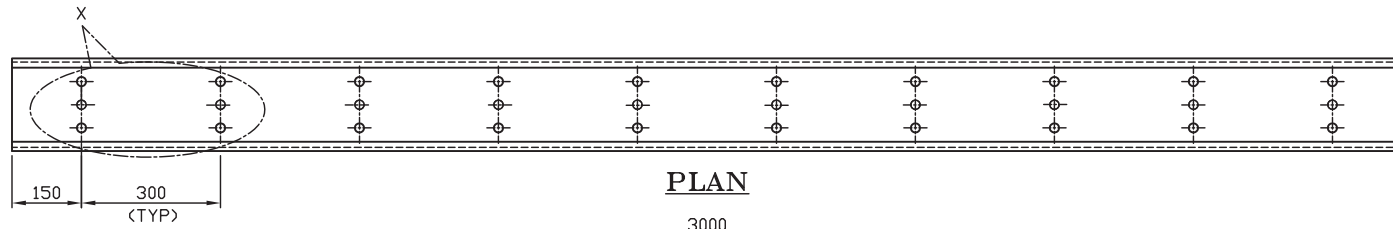

NOTES :  
1. ALL DIMENSIONS ARE IN MM

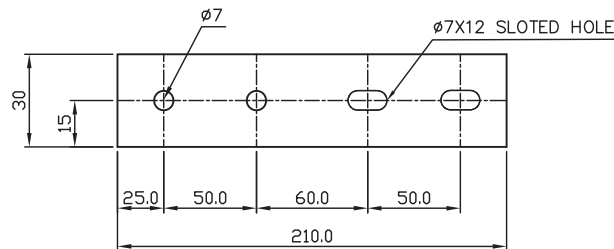
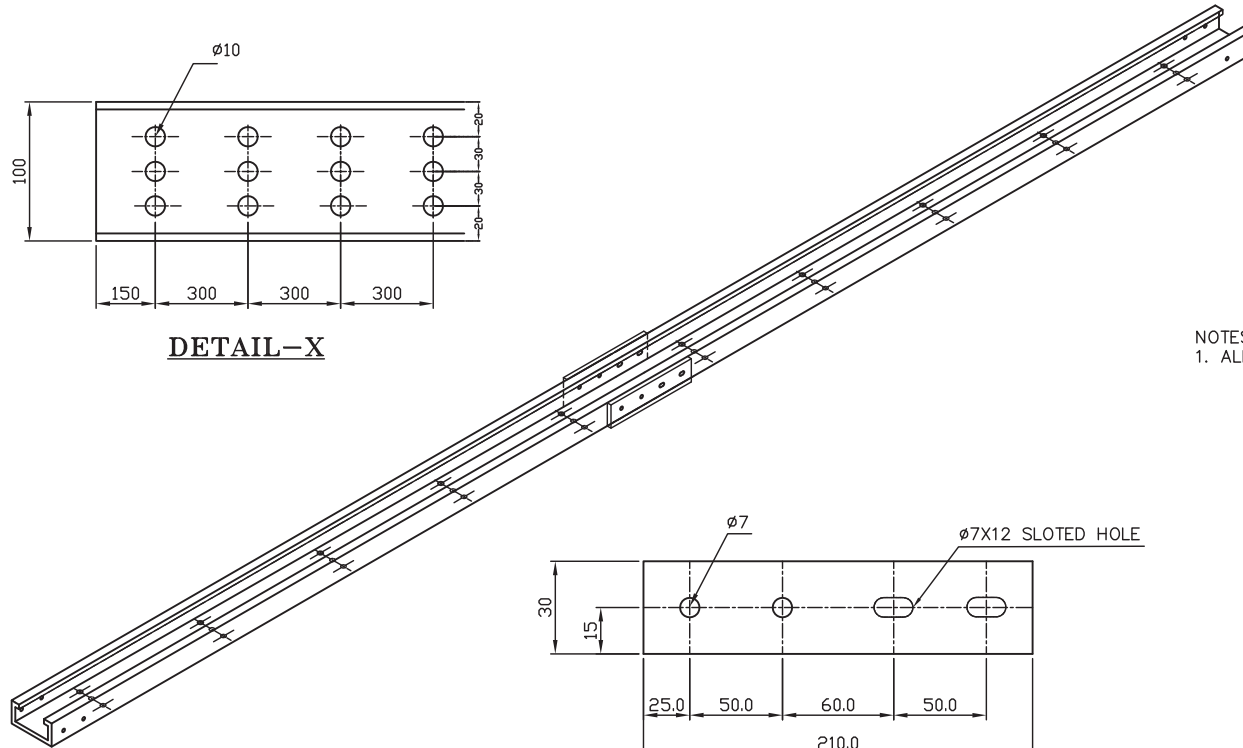

FRP COUPLER PLATE  
SIZE: 30x4x210mm LONG

CABLE TRAY REQUIRED 8 SETS OF  
SS HARDWARE

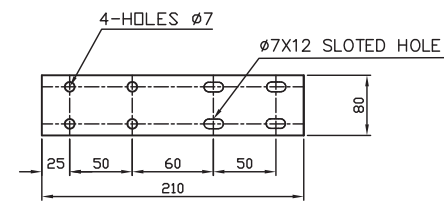
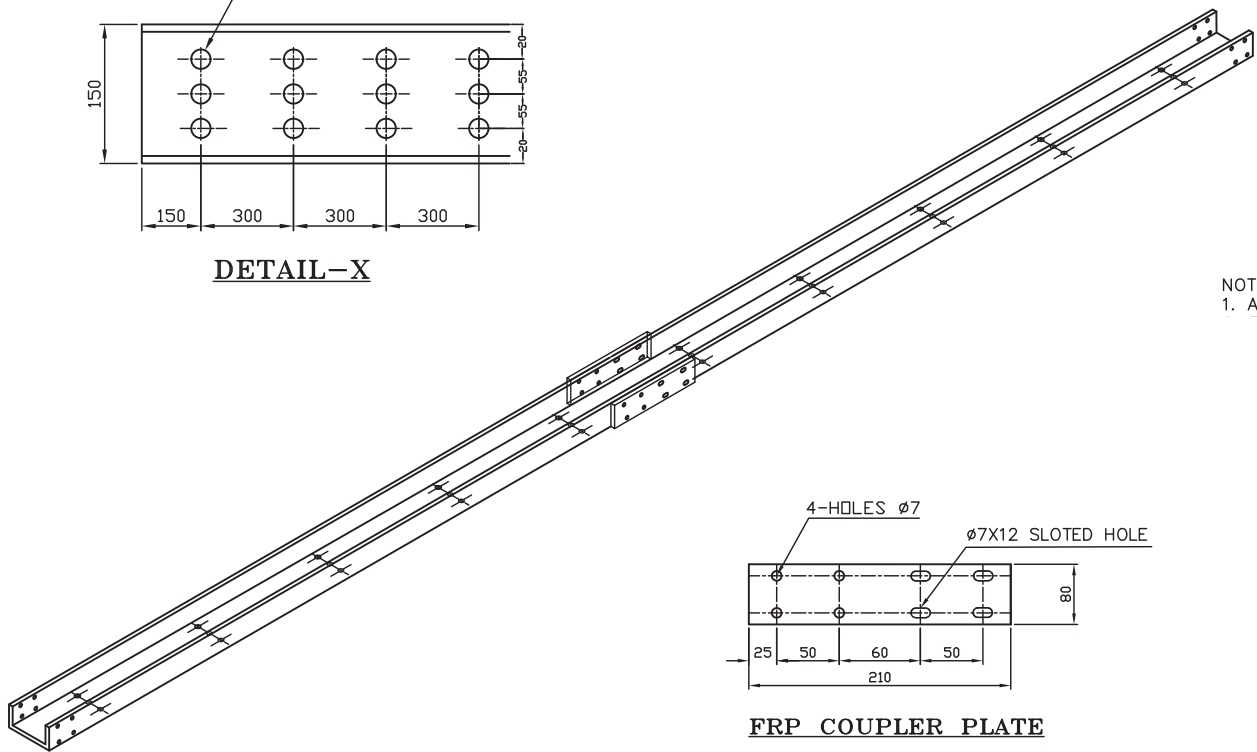
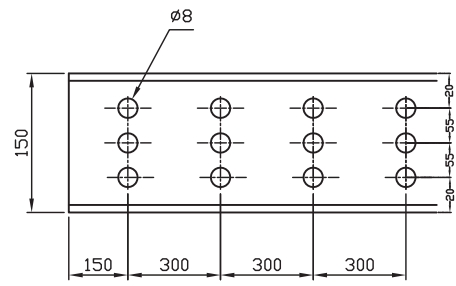
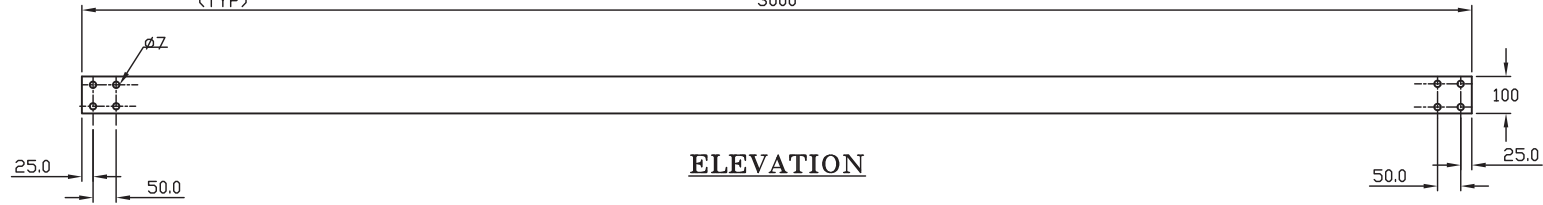
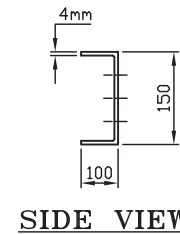
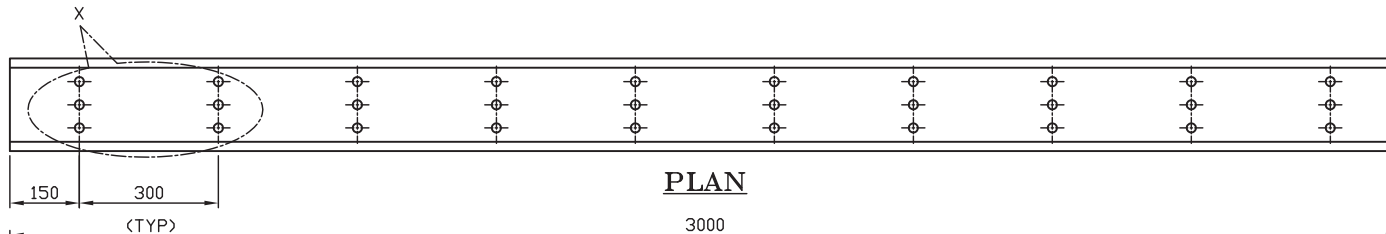

**FRP COUPLER PLATE**  
**SIZE: 80x4x210mm LONG**

CABLE TRAY REQUIRED 8 SETS OF  
 SS HARDWARE

NOTES :  
 1. ALL DIMENSIONS ARE IN MM

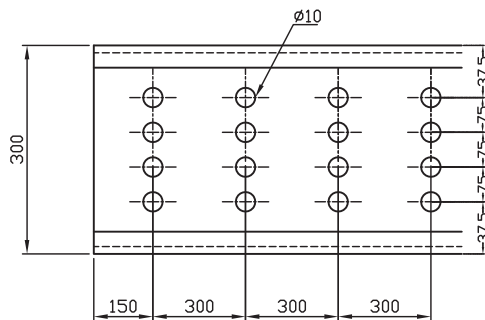
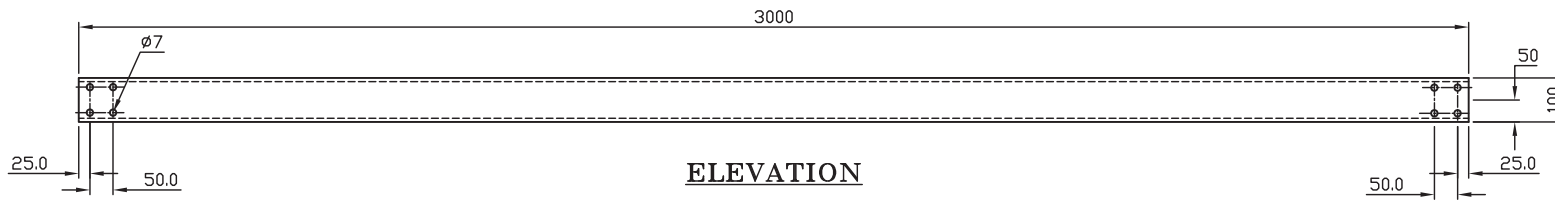
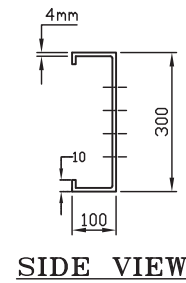
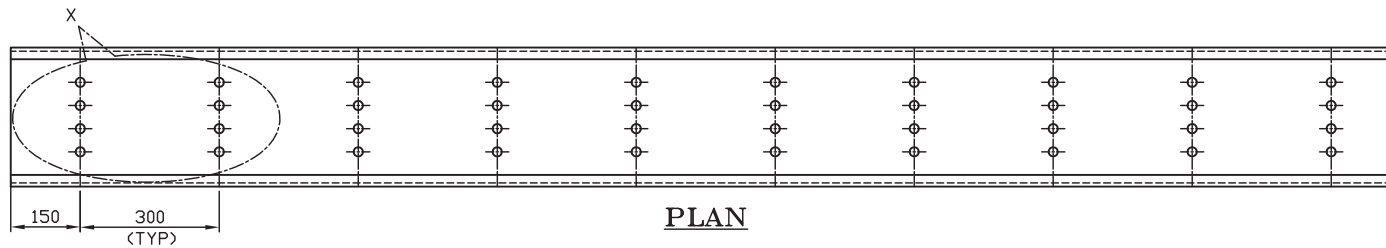

NOTES :  
1. ALL DIMENSIONS ARE IN MM

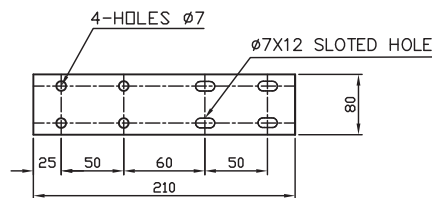
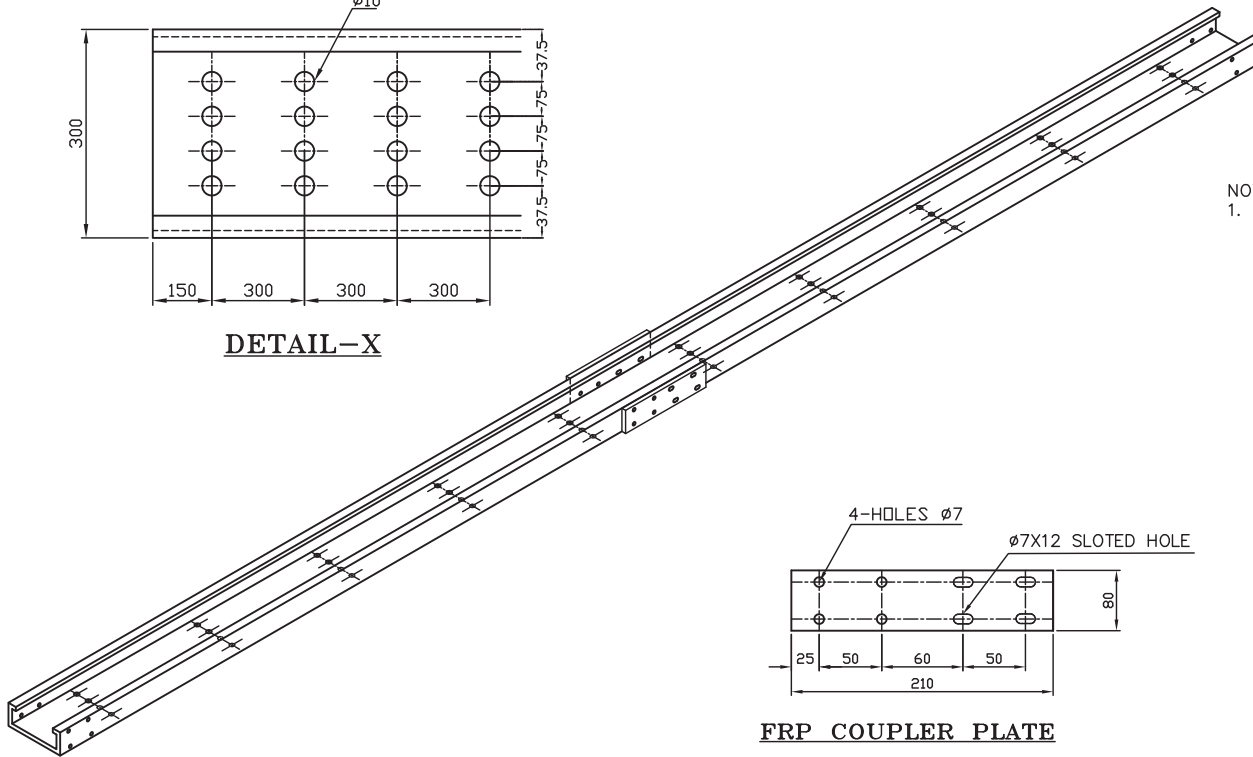

CABLE TRAY REQUIRED 8 SETS OF  
SS HARDWARE

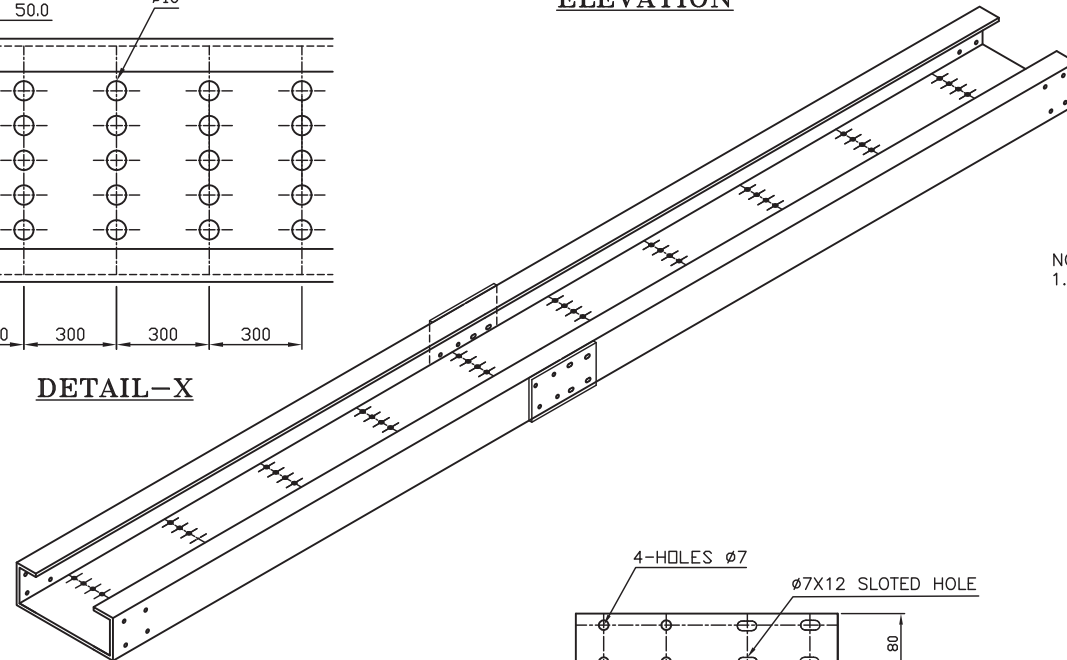
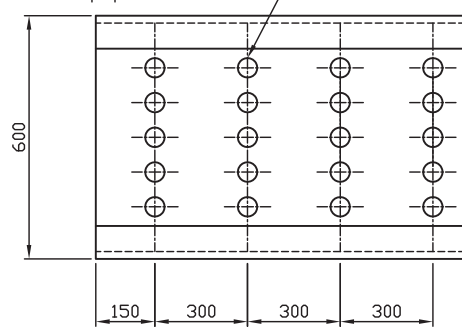
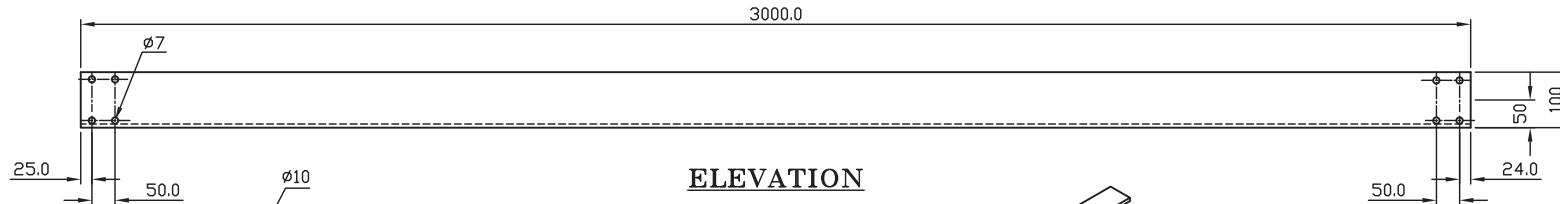
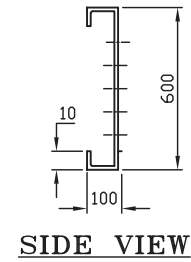
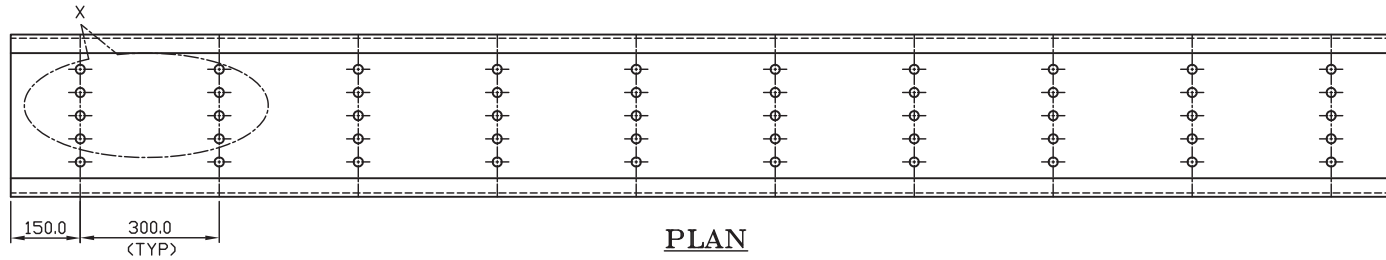

NOTES :  
1. ALL DIMENSIONS ARE IN MM

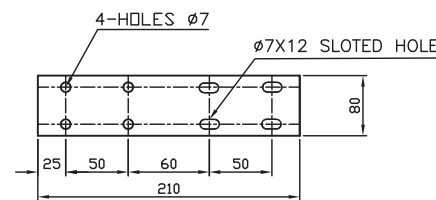

**SIZE: 80x4x210mm LONG**

CABLE TRAY REQUIRED 8 SETS OF  
SS HARDWARE

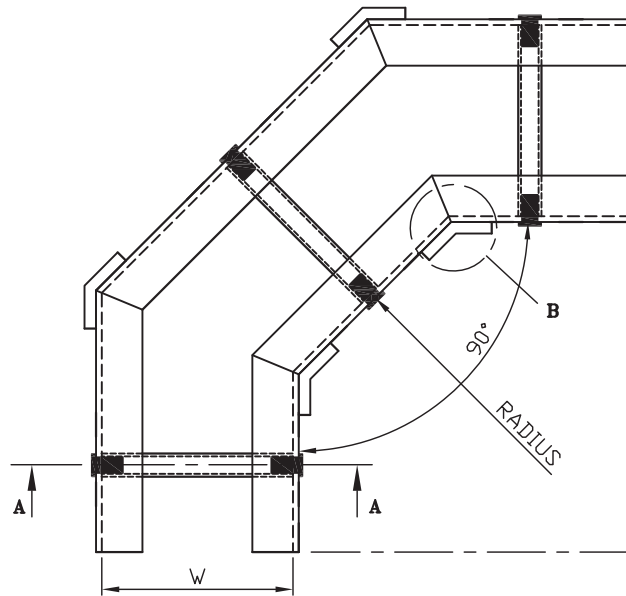

**90° HORIZONTAL BEND LADDER TYPE**

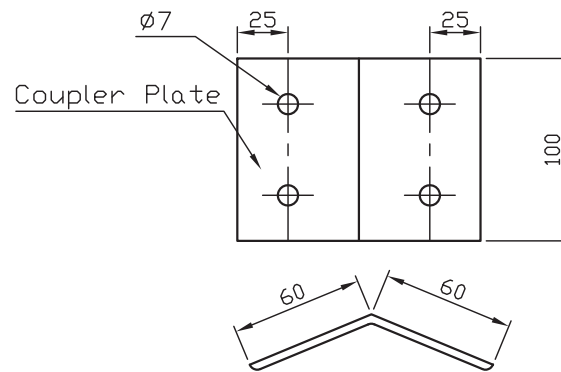
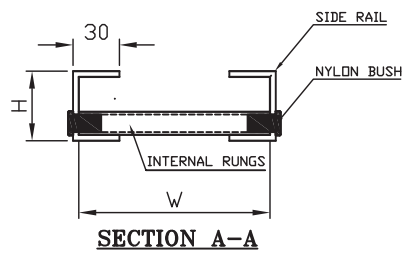

**DETAIL-B**

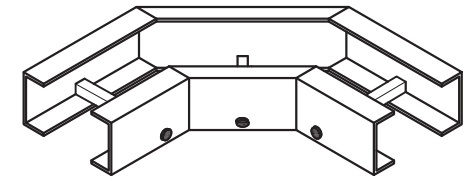

**90° HORIZONTAL BEND**

W	RADIUS	H	THK
150mm	600mm	100mm	4mm
300mm	600mm	100mm	4mm
600mm	600mm	100mm	4mm

NOTES :  
1. ALL DIMENSIONS ARE IN MM

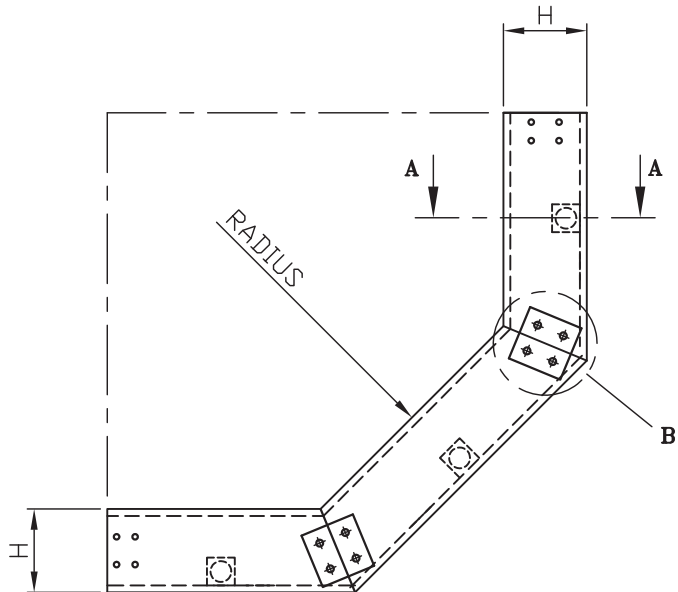

**90° VERTICAL INSIDE BEND LADDER TYPE**

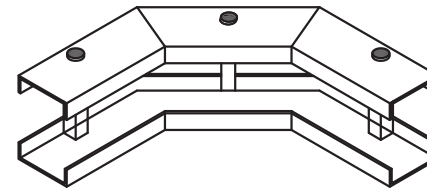

**90° VERTICAL INSIDE BEND**

W	RADIUS	H	THK
150mm	600mm	100mm	4mm
300mm	600mm	100mm	4mm
600mm	600mm	100mm	4mm

NOTES :  
1. ALL DIMENSIONS ARE IN MM

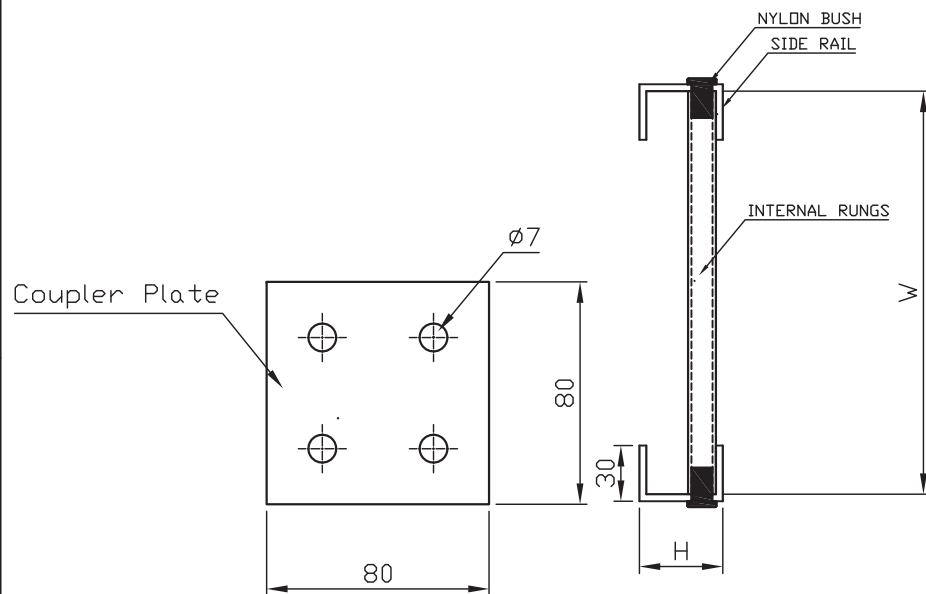

**SIDE VIEW OF DETAIL-B**

**SECTION A-A**



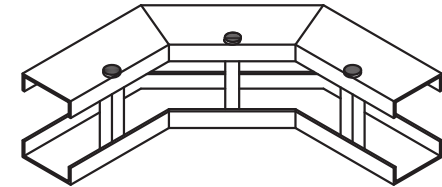
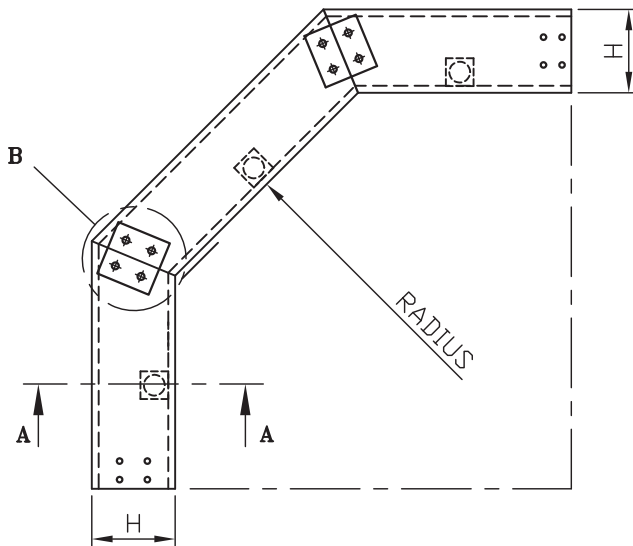

**90° VERTICAL OUTSIDE BEND**

W	RADIUS	H	THK
150mm	600mm	100mm	4mm
300mm	600mm	100mm	4mm
600mm	600mm	100mm	4mm

NOTES :

1. ALL DIMENSIONS ARE IN MM

**90° VERTICAL OUTSIDE BEND LADDER TYPE**

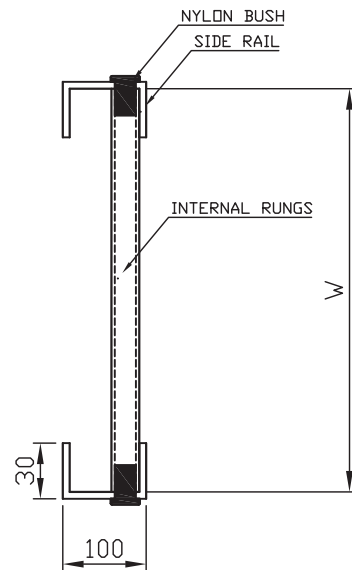

**SECTION A-A**

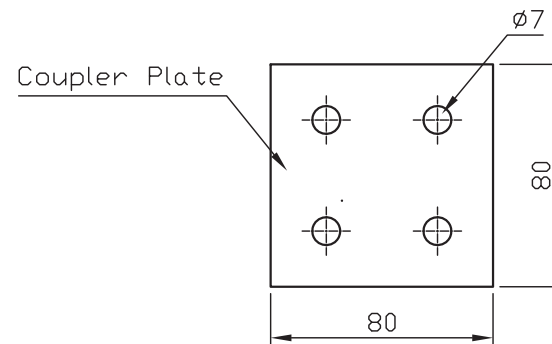

**SIDE VIEW OF DETAIL-B**

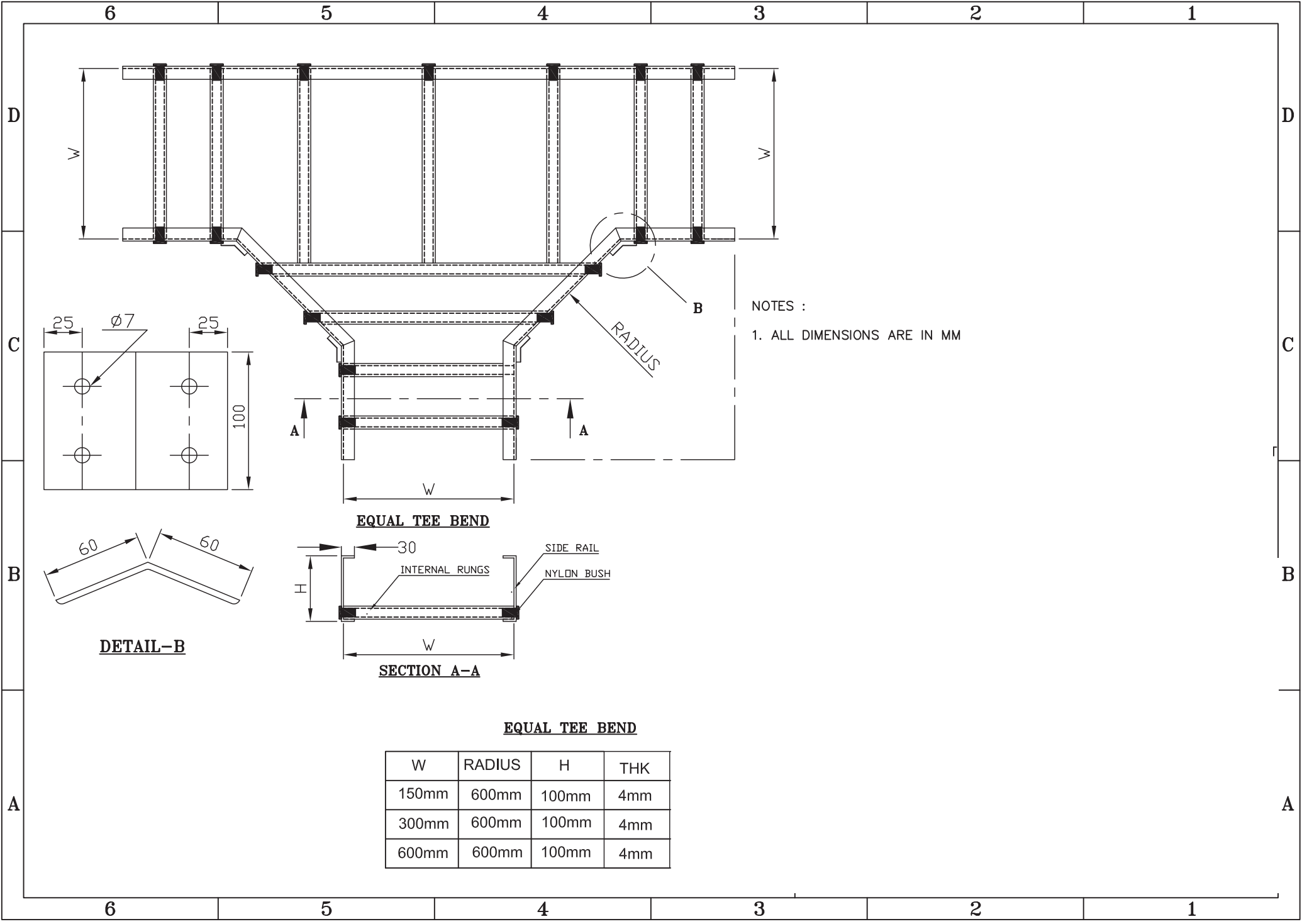

NOTES :  
1. ALL DIMENSIONS ARE IN MM

**EQUAL TEE BEND**

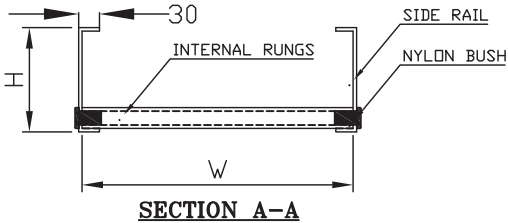

**SECTION A-A**

**DETAIL-B**

**EQUAL TEE BEND**

W	RADIUS	H	THK
150mm	600mm	100mm	4mm
300mm	600mm	100mm	4mm
600mm	600mm	100mm	4mm

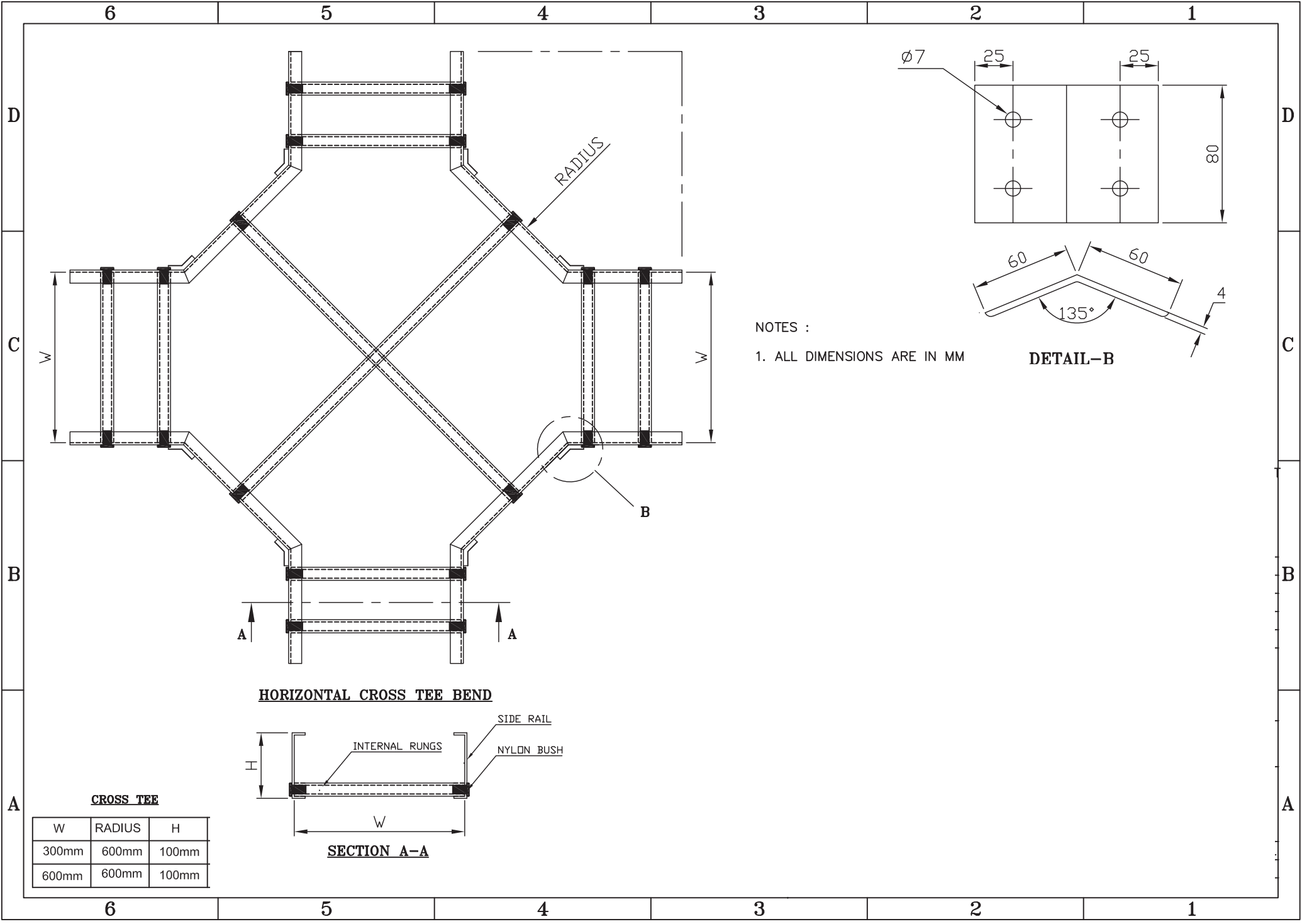

CROSS TEE		
W	RADIUS	H
300mm	600mm	100mm
600mm	600mm	100mm

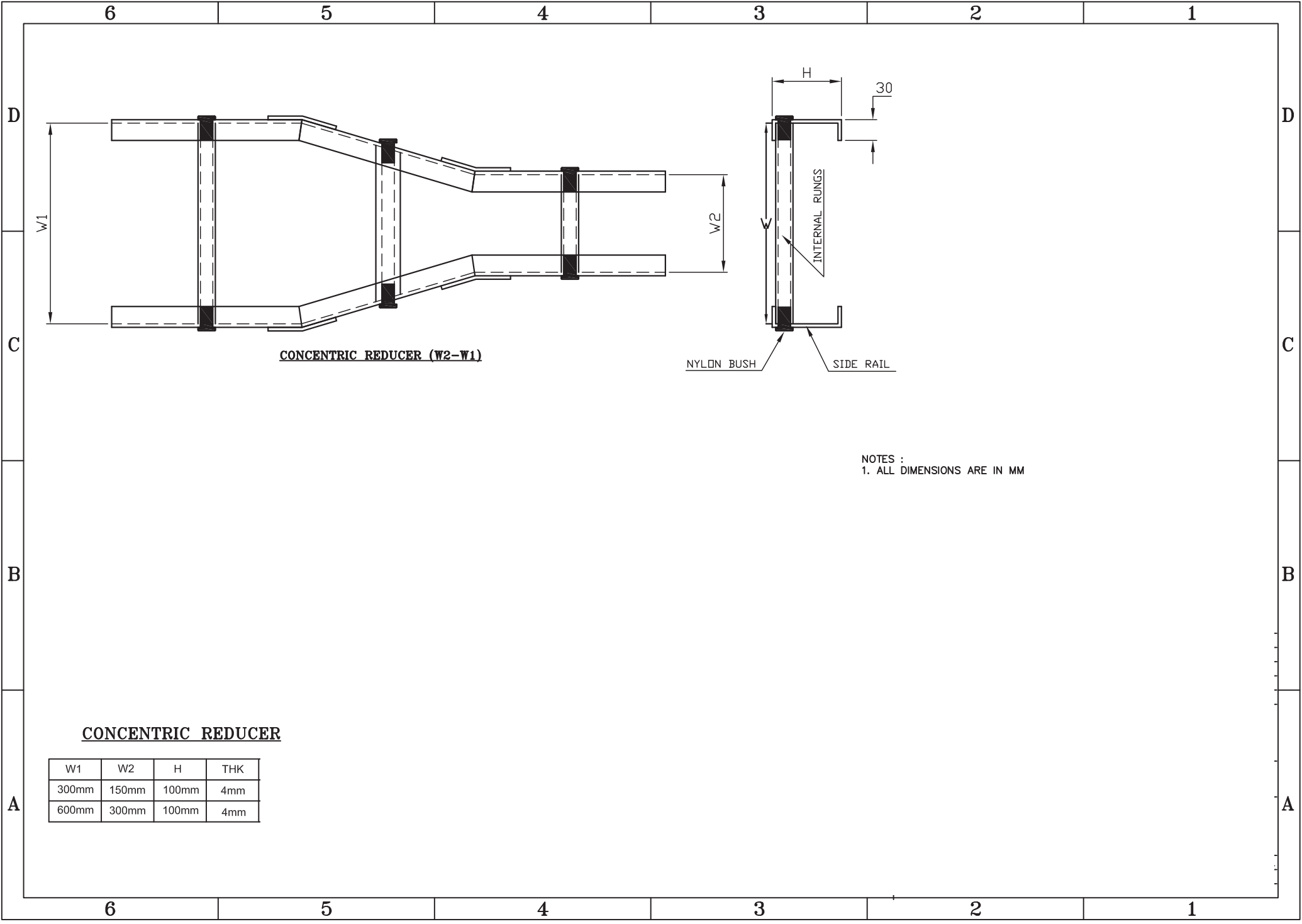

CONCENTRIC REDUCER (W2-W1)

NYLON BUSH

SIDE RAIL

NOTES :  
1. ALL DIMENSIONS ARE IN MM

CONCENTRIC REDUCER

W1	W2	H	THK
300mm	150mm	100mm	4mm
600mm	300mm	100mm	4mm

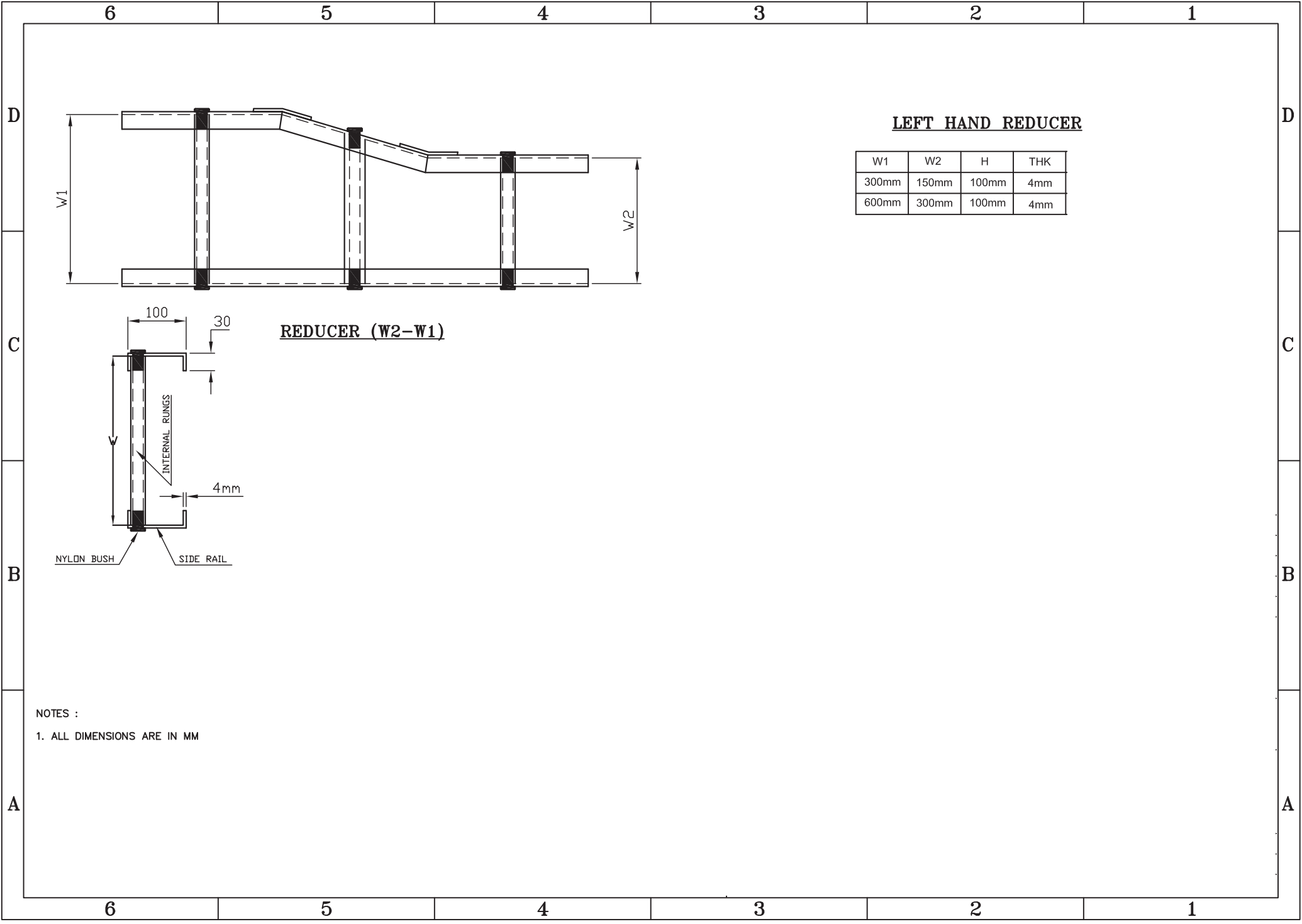

**LEFT HAND REDUCER**

W1	W2	H	THK
300mm	150mm	100mm	4mm
600mm	300mm	100mm	4mm

**REDUCER (W2-W1)**

NOTES :  
1. ALL DIMENSIONS ARE IN MM

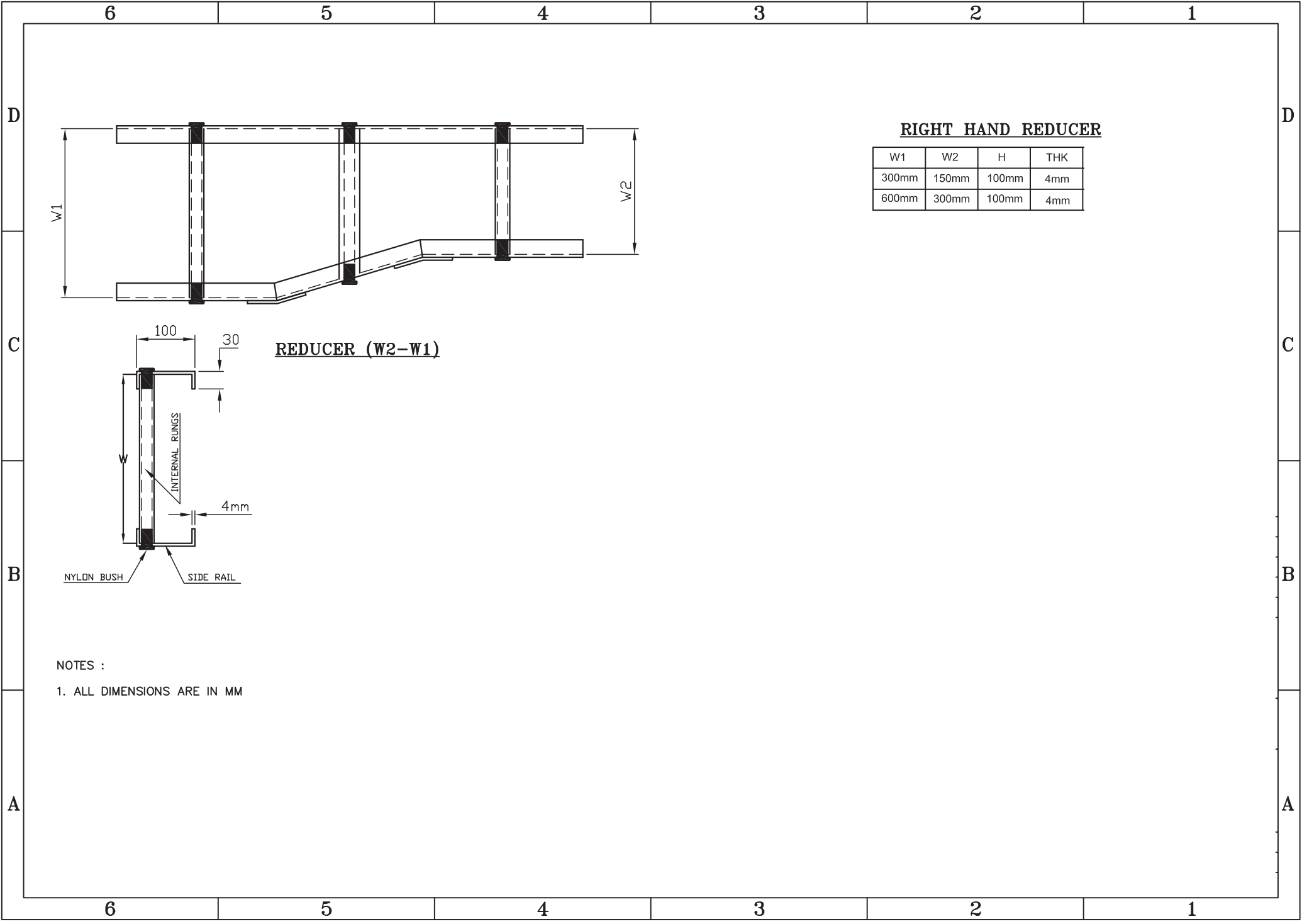

**RIGHT HAND REDUCER**

W1	W2	H	THK
300mm	150mm	100mm	4mm
600mm	300mm	100mm	4mm

**REDUCER (W2-W1)**

NOTES :  
1. ALL DIMENSIONS ARE IN MM

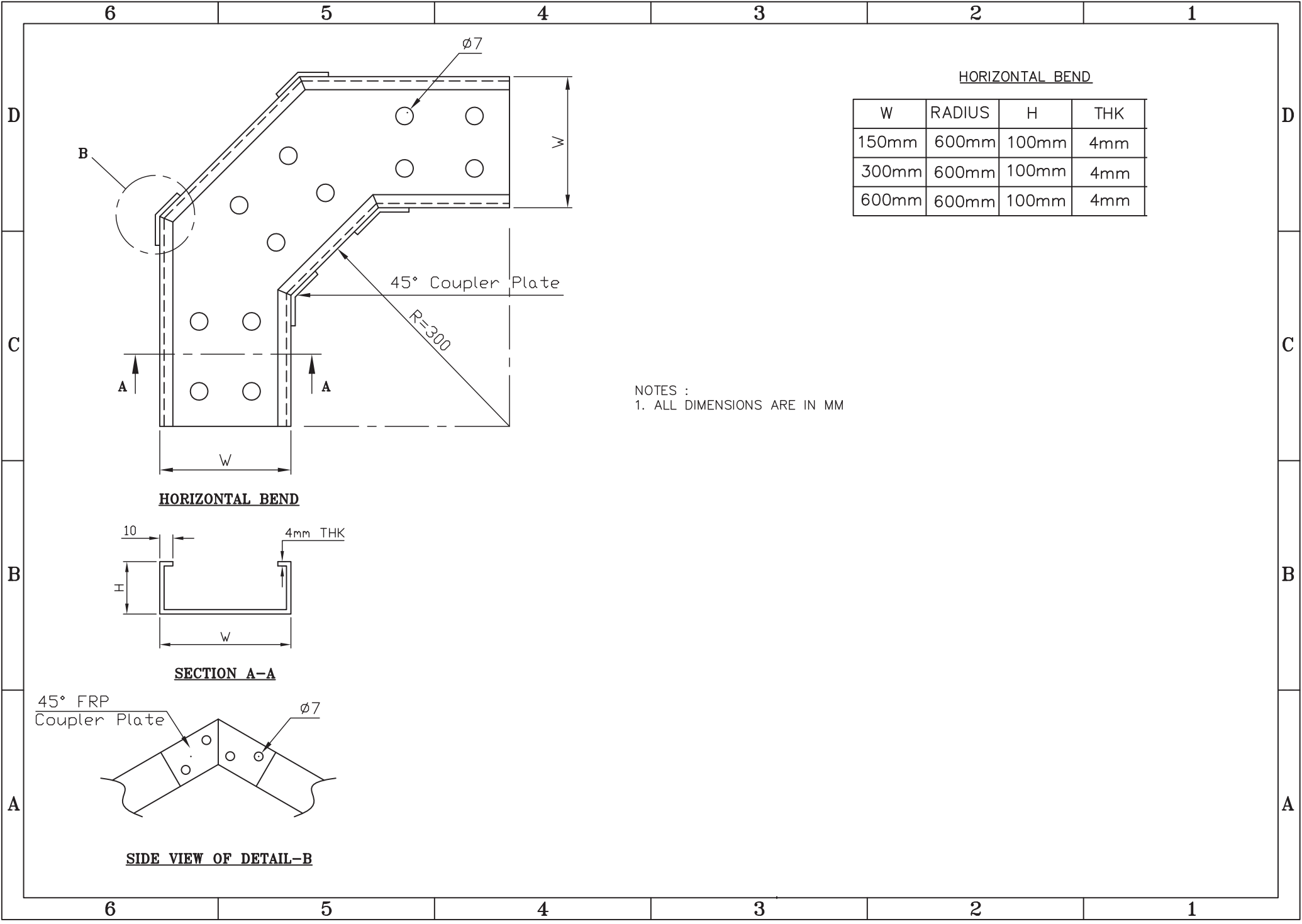

HORIZONTAL BEND

W	RADIUS	H	THK
150mm	600mm	100mm	4mm
300mm	600mm	100mm	4mm
600mm	600mm	100mm	4mm

NOTES :  
1. ALL DIMENSIONS ARE IN MM

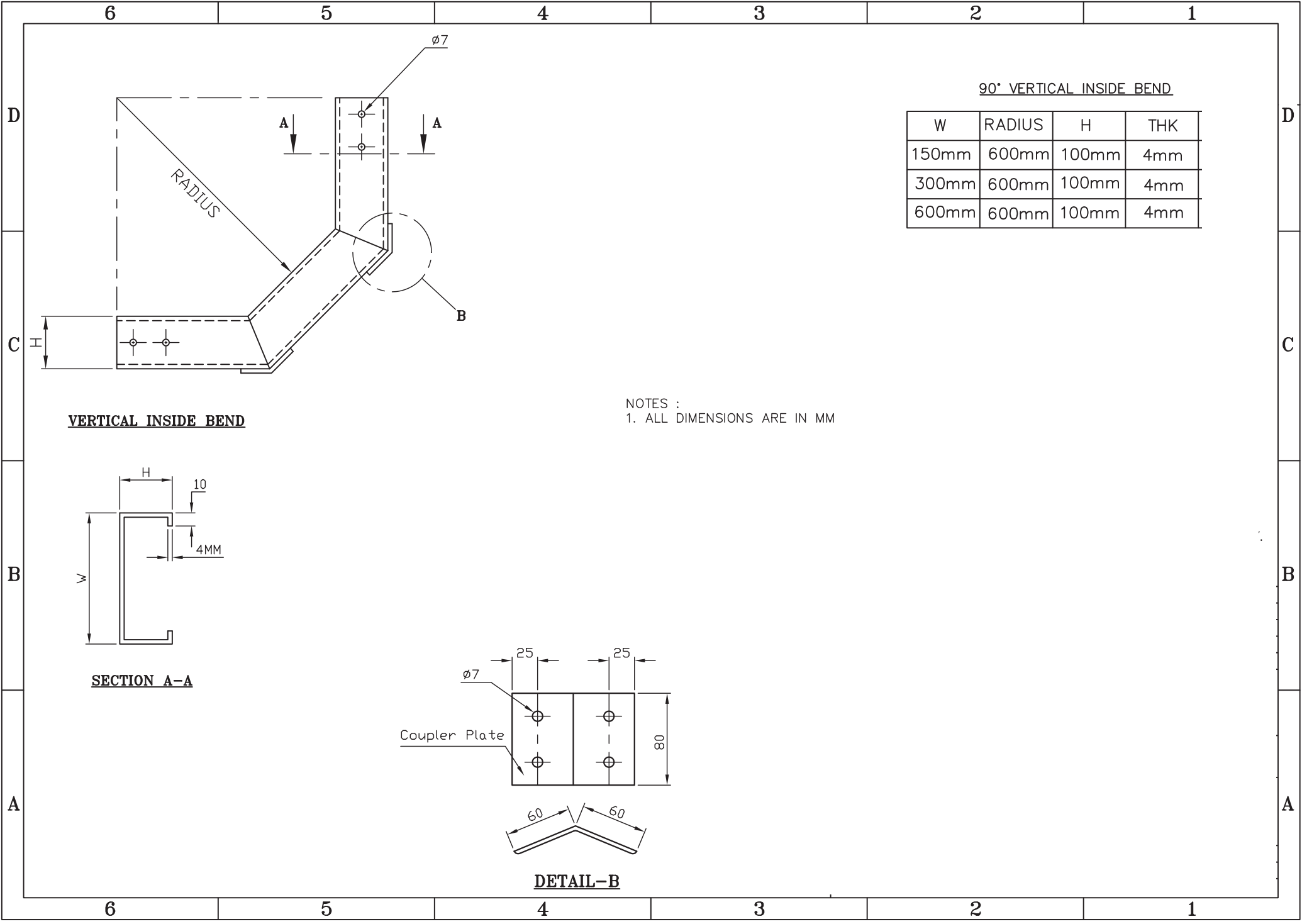

90° VERTICAL INSIDE BEND

W	RADIUS	H	THK
150mm	600mm	100mm	4mm
300mm	600mm	100mm	4mm
600mm	600mm	100mm	4mm

VERTICAL INSIDE BEND

NOTES :  
1. ALL DIMENSIONS ARE IN MM

SECTION A-A

DETAIL-B



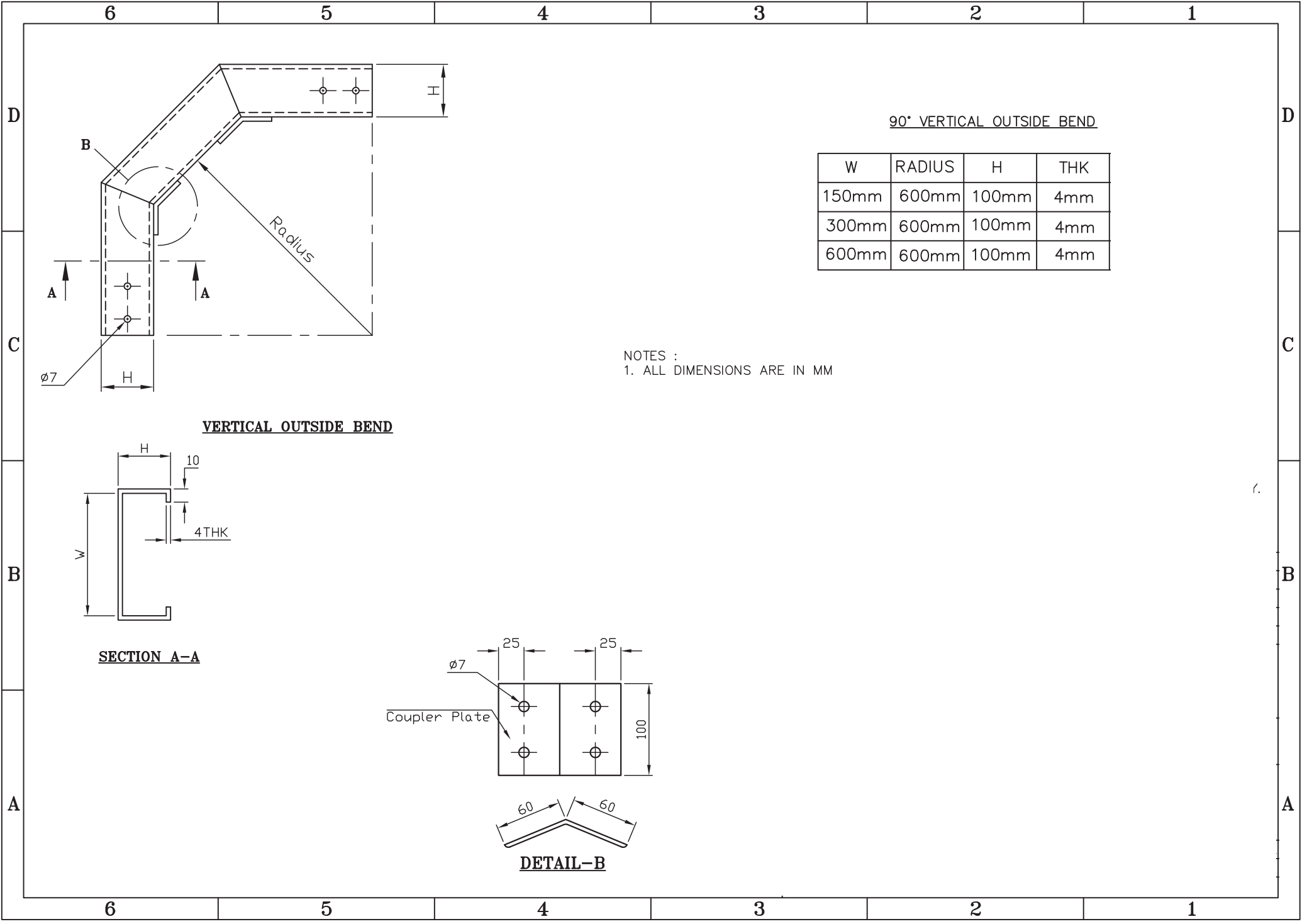

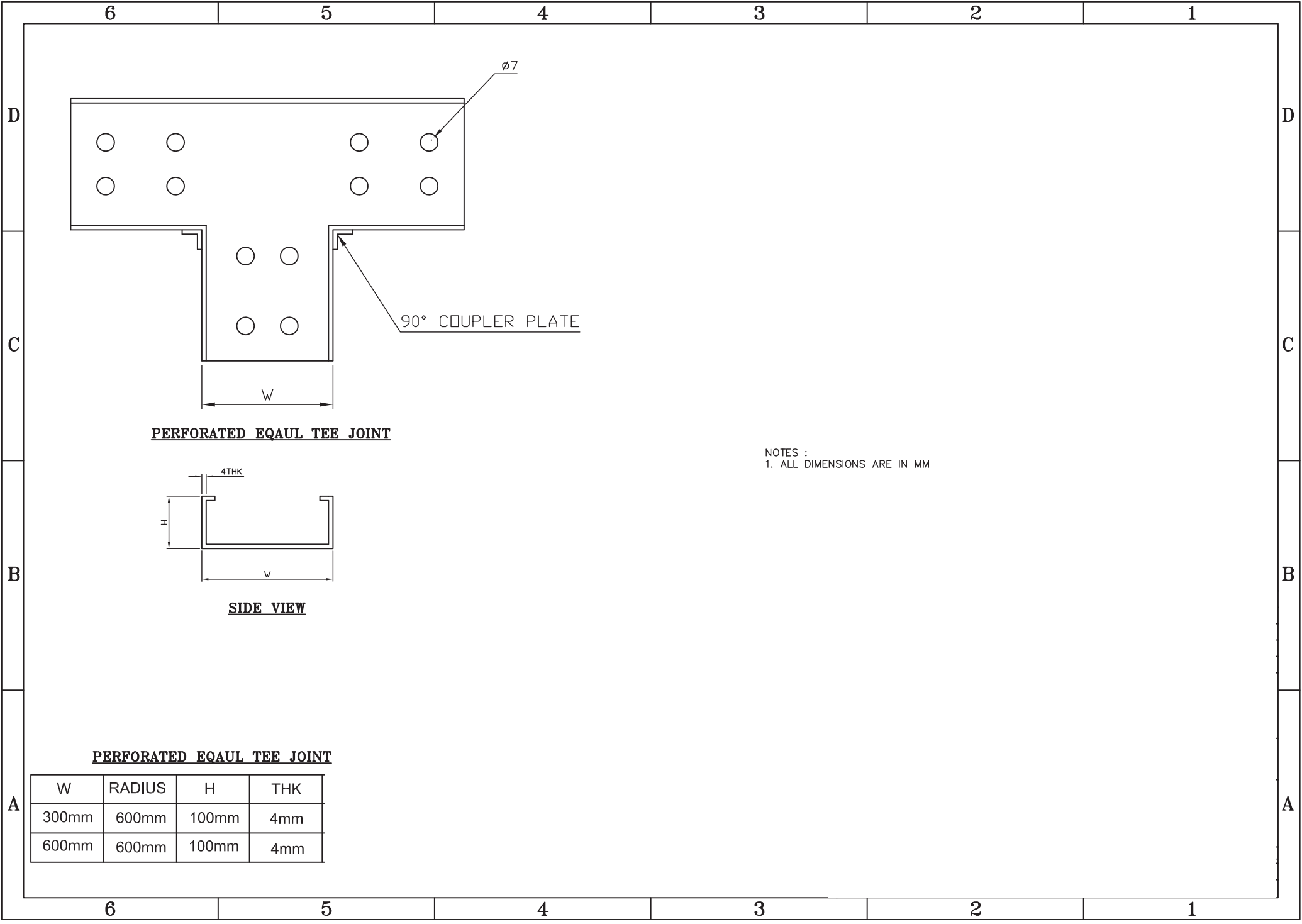

6 5 4 3 2 1

D

D

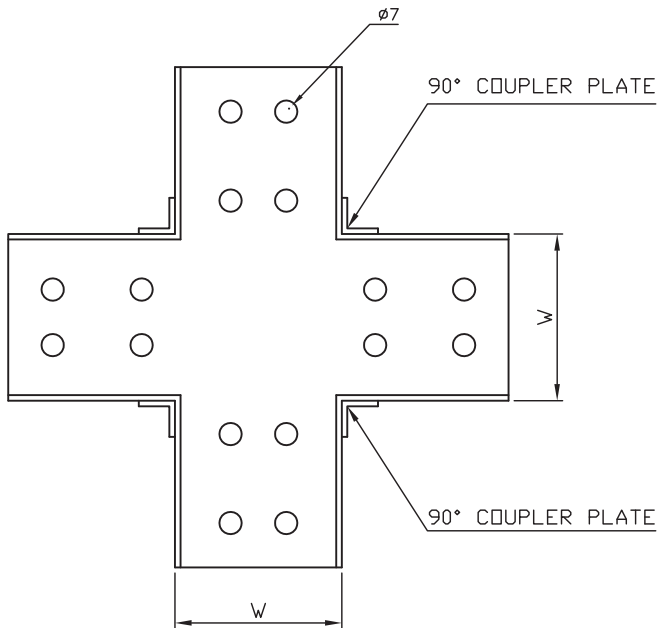

**PERFORATED CROSS TEE JOINT**

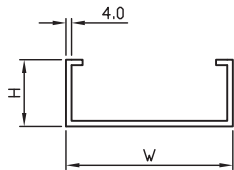

**SECTION A-A**

NOTES :  
1. ALL DIMENSIONS ARE IN MM

**PERFORATED CROSS TEE JOINT**

W	RADIUS	H	THK
300mm	600mm	100mm	4mm
600mm	600mm	100mm	4mm

6 5 4 3 2 1

A

A

